





-  PROPOSED DEVELOPMENT AREAS
-  PROPOSED APRON AREAS
-  FUTURE PAVEMENTS
-  EXISTING GAS
-  EXISTING TELEPHONE
-  EXISTING WATER
-  EXISTING SANITARY
-  EXISTING ELECTRIC
-  EXISTING STORM SEWER
-  EXISTING AIRPORT PROPERTY LINE
-  EXISTING FLOODWAY
-  EXISTING FLOODPLAIN

NOTES:
 1. THESE SITES HAVE FLOOD PLAIN RESTRICTIONS
 2. ASR - AIRFIELD SURVEILLANCE RADAR



REVISIONS		
NUMBER	BY	DATE

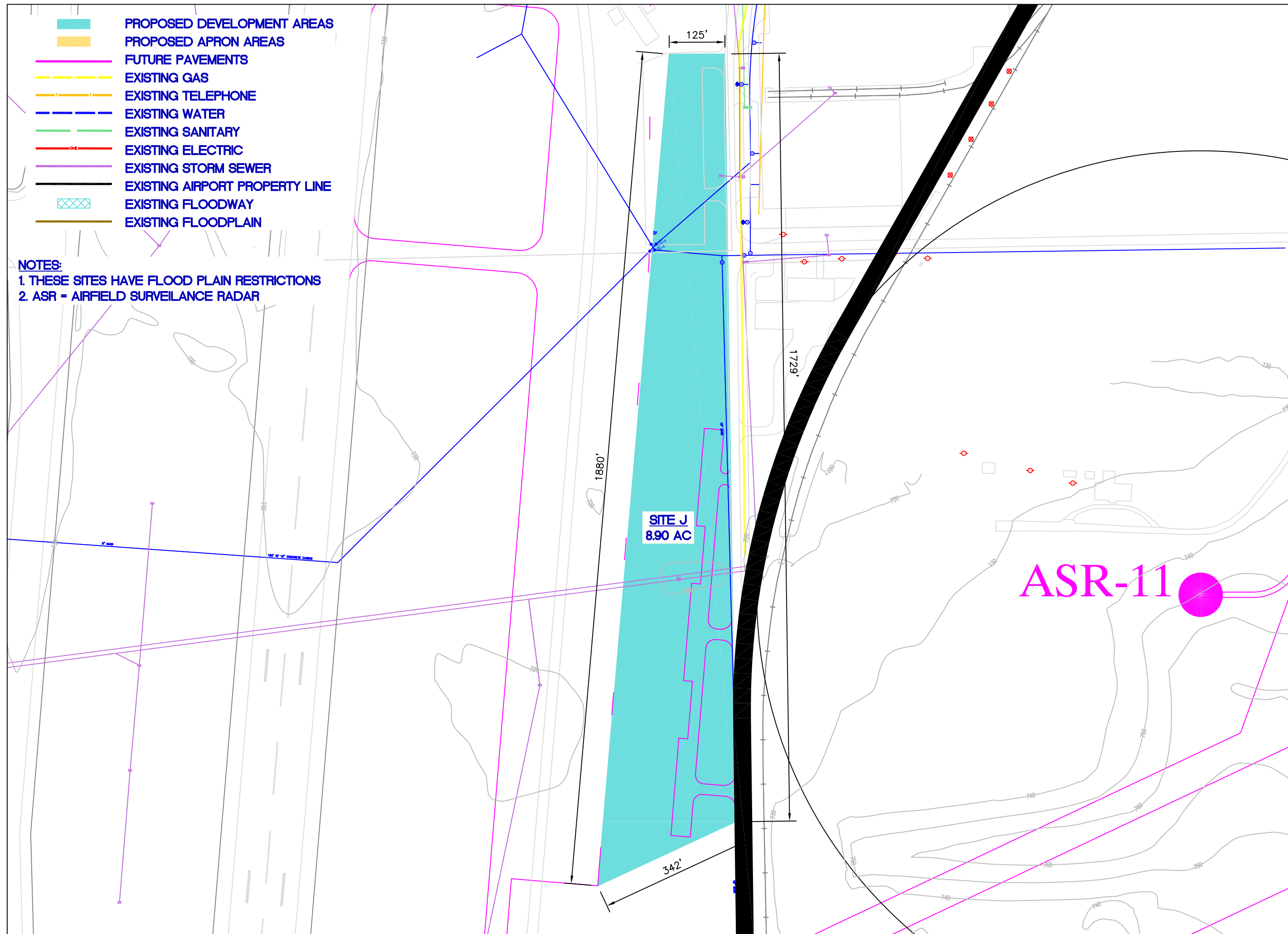

GREATER ROCKFORD AIRPORT
ROCKFORD, ILLINOIS

PROPOSED DEVELOPMENT
AREAS AND FUTURE PAVEMENTS

© Copyright CMT, Inc.
CMT
 CRAWFORD, MURPHY & TILLY, INC.
 CONSULTING ENGINEERS
 License No. 84-000613

Chicago /
Rockford
International
Airport



DESIGN BY:
 DRAWN BY: CMT / RFD
 CHECKED BY:
 APPROVED BY:
 DATE: 07/18/07
 JOB No: 07258-01-00

SITE J
 SHEET 10 OF 15 SHEETS