

- PROPOSED DEVELOPMENT AREAS
- PROPOSED APRON AREAS
- FUTURE PAVEMENTS
- EXISTING GAS
- EXISTING TELEPHONE
- EXISTING WATER
- EXISTING SANITARY
- EXISTING ELECTRIC
- EXISTING STORM SEWER
- EXISTING AIRPORT PROPERTY LINE
- EXISTING FLOODWAY
- EXISTING FLOODPLAIN

NOTES:
 1. THESE SITES HAVE FLOOD PLAIN RESTRICTIONS
 2. ASR = AIRFIELD SURVEILLANCE RADAR

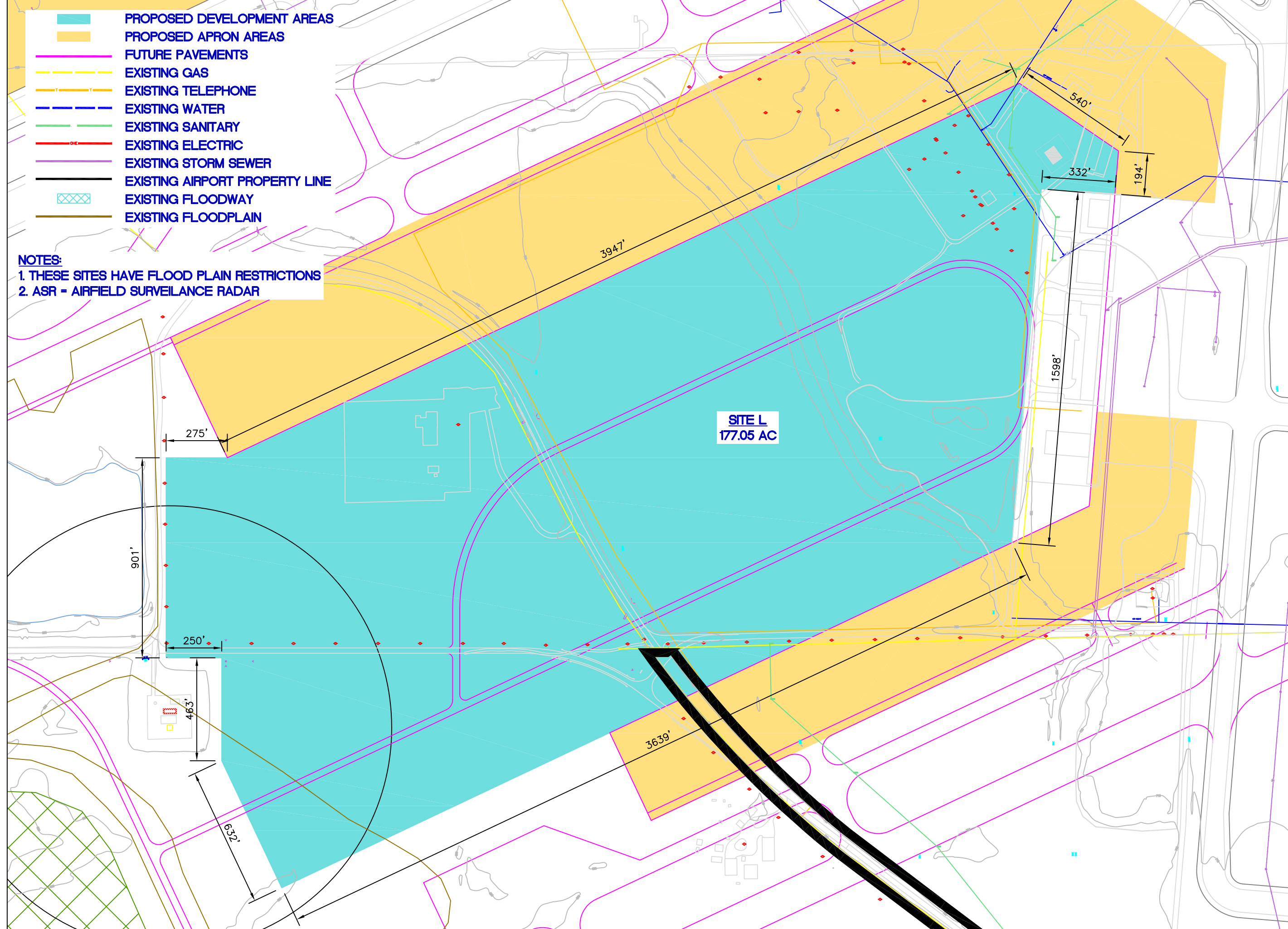

REVISIONS		
NUMBER	BY	DATE



**GREATER ROCKFORD AIRPORT
 ROCKFORD, ILLINOIS**

**PROPOSED DEVELOPMENT
 AREAS AND FUTURE PAVEMENTS**

© Copyright CMT, Inc.

CMT
 CRAWFORD, MURPHY & TILLY, INC.
 CONSULTING ENGINEERS
 License No. 184-000613

**Chicago /
 Rockford
 International
 Airport**

DESIGN BY:
 DRAWN BY: CMT / RFD
 CHECKED BY:
 APPROVED BY:
 DATE: 07/18/07
 JOB No: 07258-01-00

SITE L